

CARRIER DIMENSIONS
Scale: 1:1

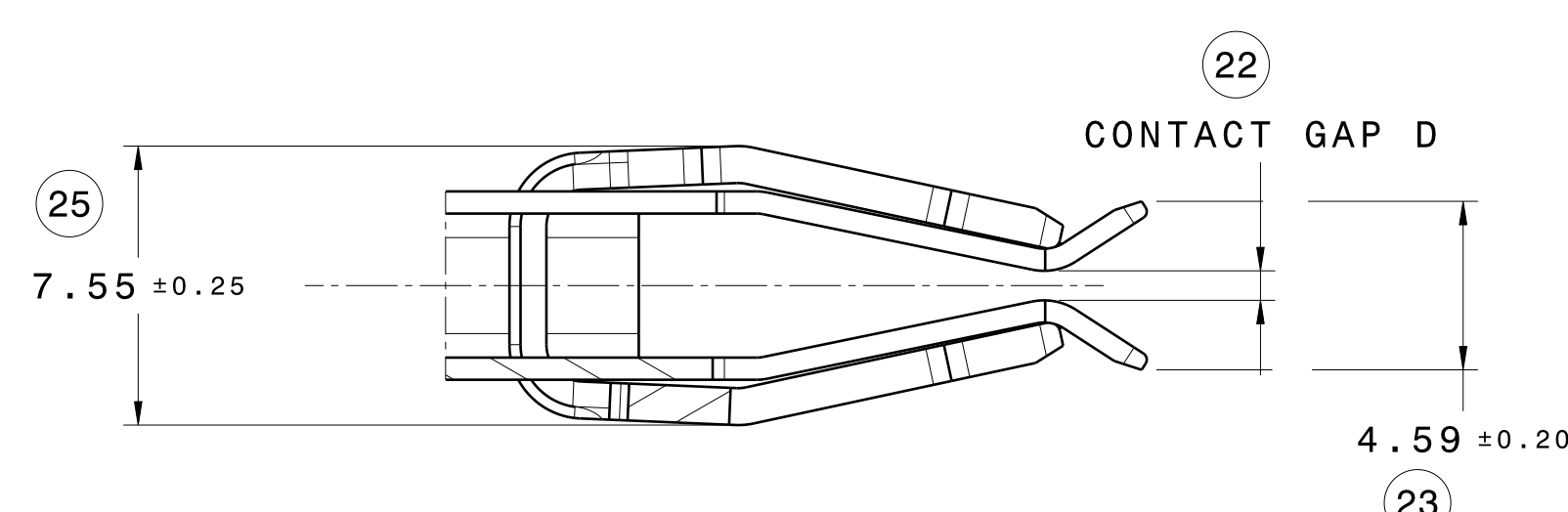

SECTION VIEW A-A
FOR PART NUMBER E22420300 ONLY
SAME AS E05750900 EXCEPT AS SHOWN

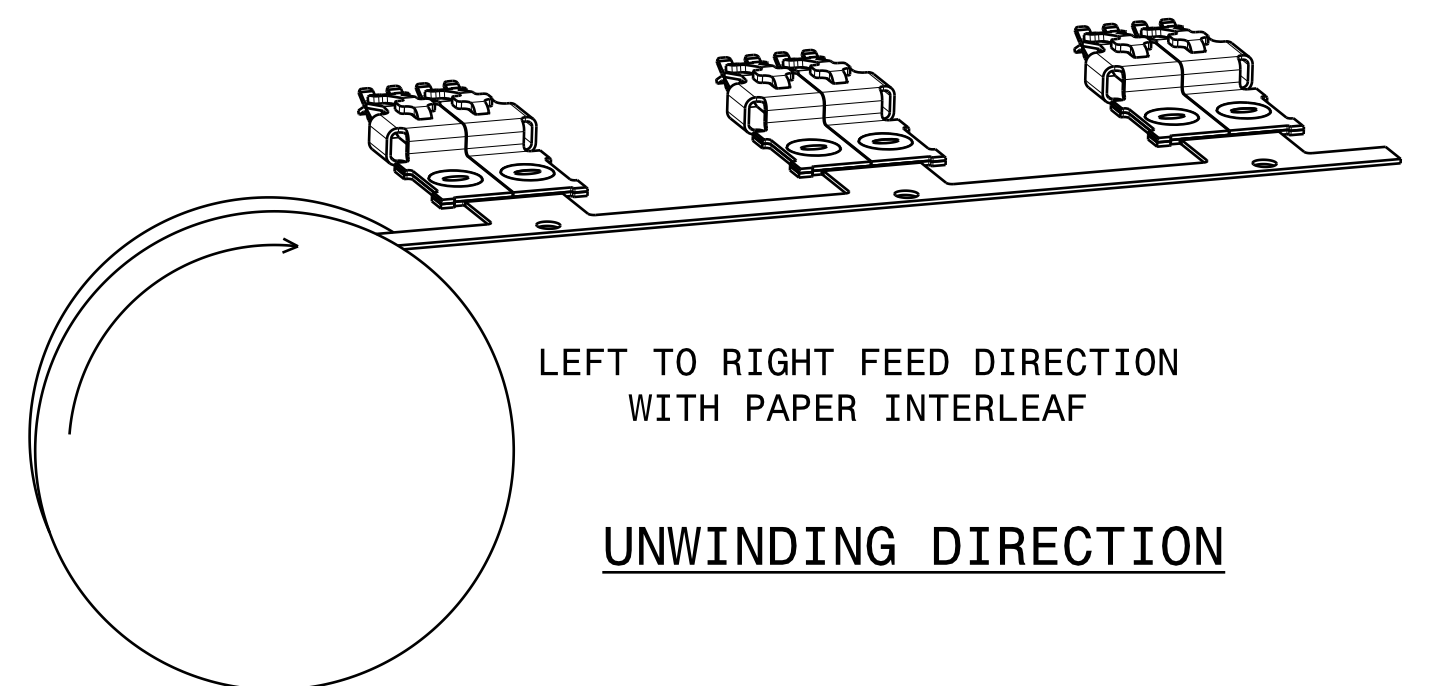
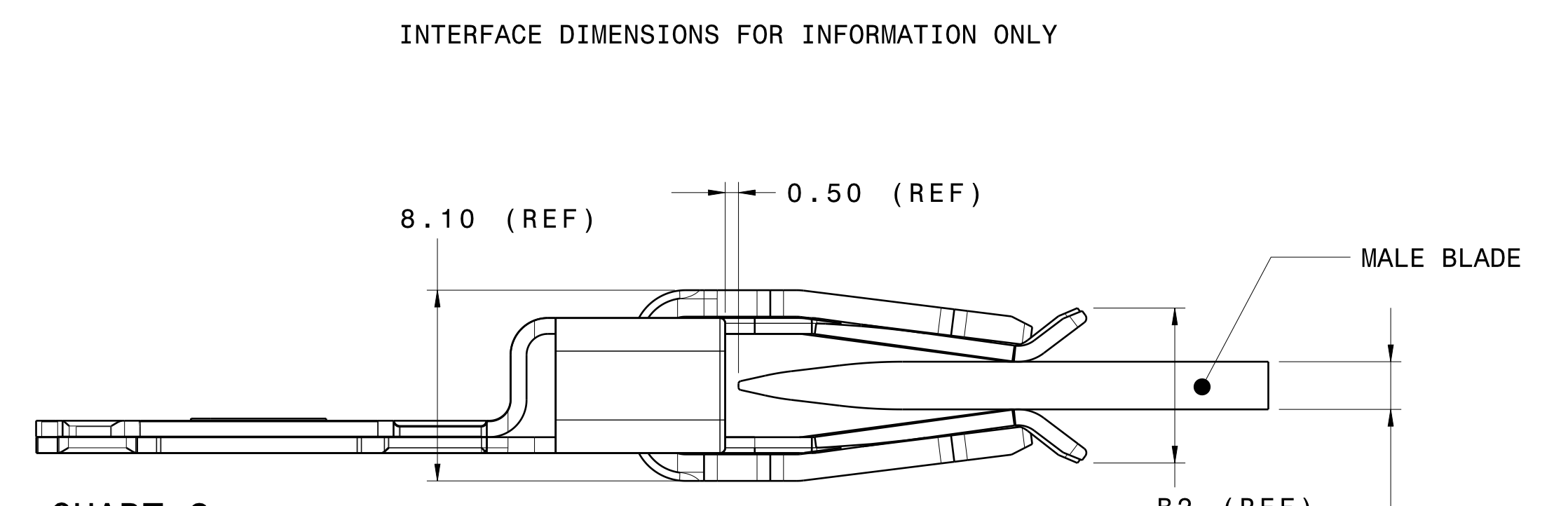
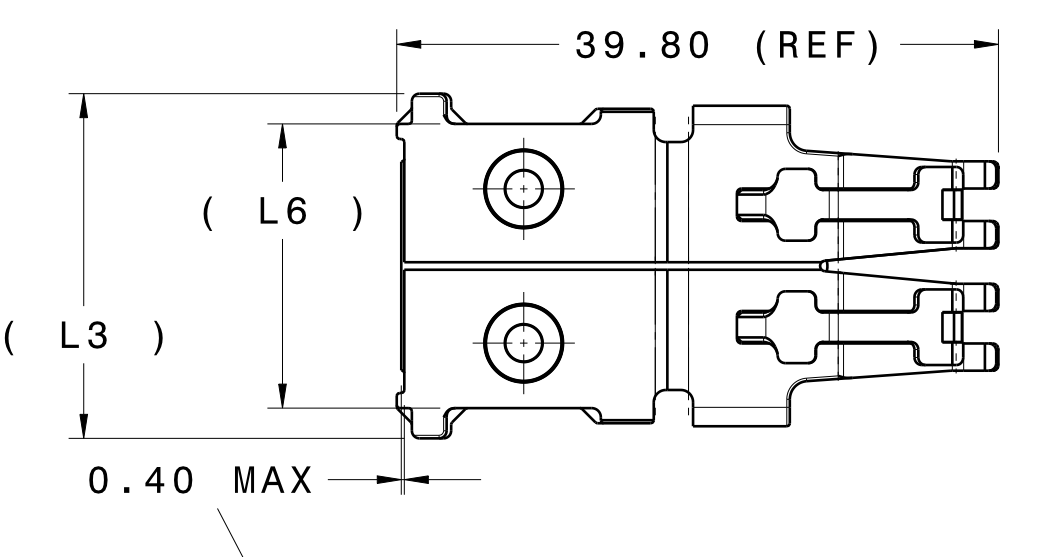

CHART 2

PART	BLADE DESCRIPTION	B1	B2	NOTE
A	14.5mm X 1.2mm BLADE	1.2	5.0	NOT TO BE USED
B	14.5mm X 1.5mm BLADE	1.5	5.4	WITH E22420300
C	14.5mm X 1.8mm BLADE	1.8	5.9	
D	14.5mm X 2.2mm BLADE	2.2	6.2	

SEE 14.5MM BLADE DRAWING FOR REQUIRED DIMENSIONS AND TOLERANCES D00061263

INTERFACE TO BLADE



TAIL AFTER SINGULATION FROM CARRIER (APPLICATOR CONTROLLED)
GPN E05750900, & E22420300
Scale: 2:1
EXTENDED TAB

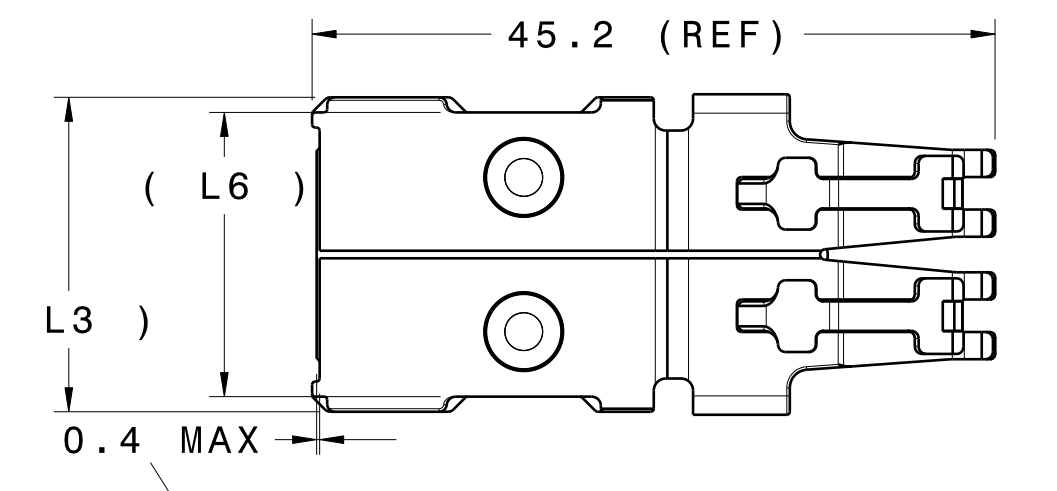

TAIL AFTER SINGULATION FROM CARRIER (APPLICATOR CONTROLLED)
GPN 2B202021F
Scale: 2:1
EXTENDED BODY

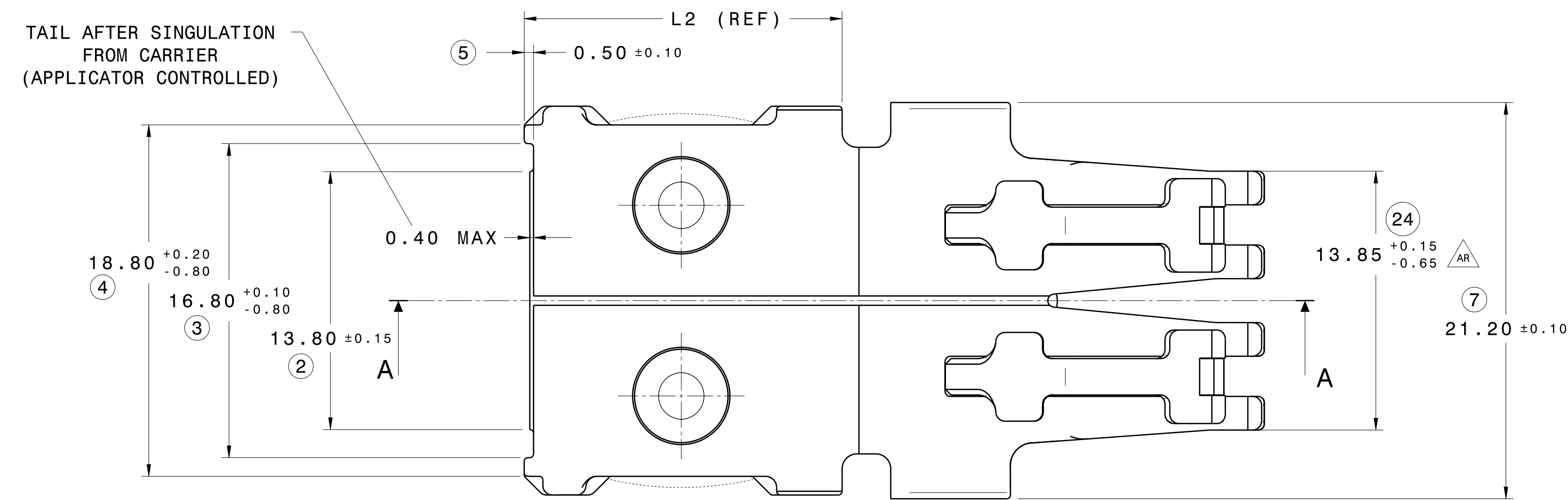

TOP VIEW

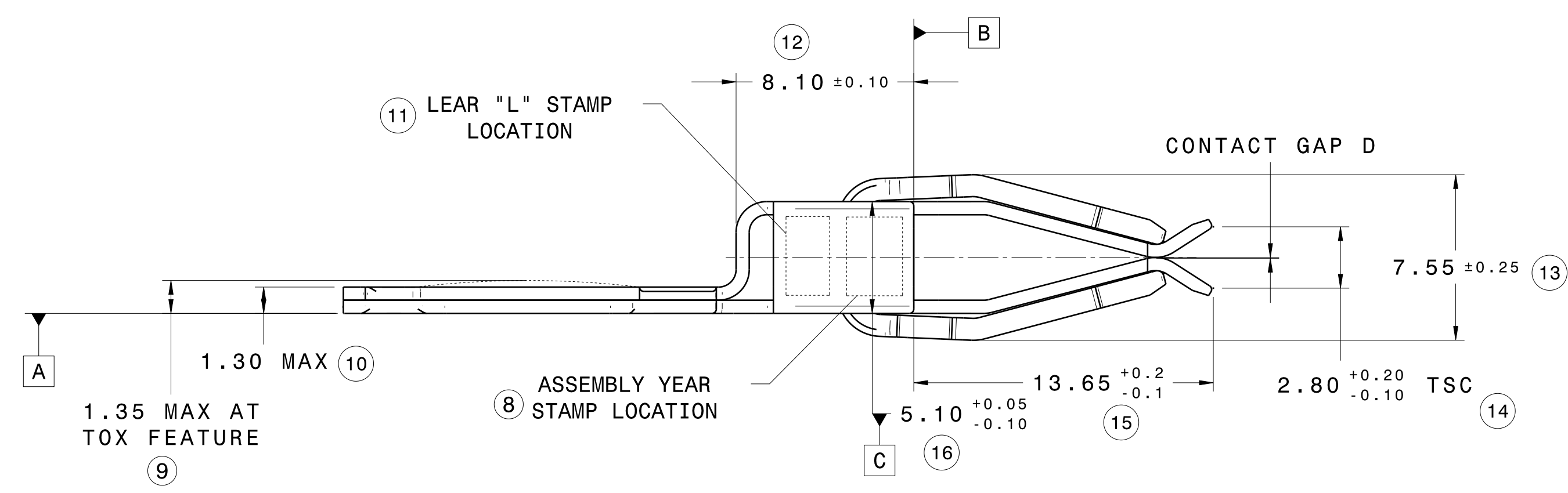

SIDE VIEW 1

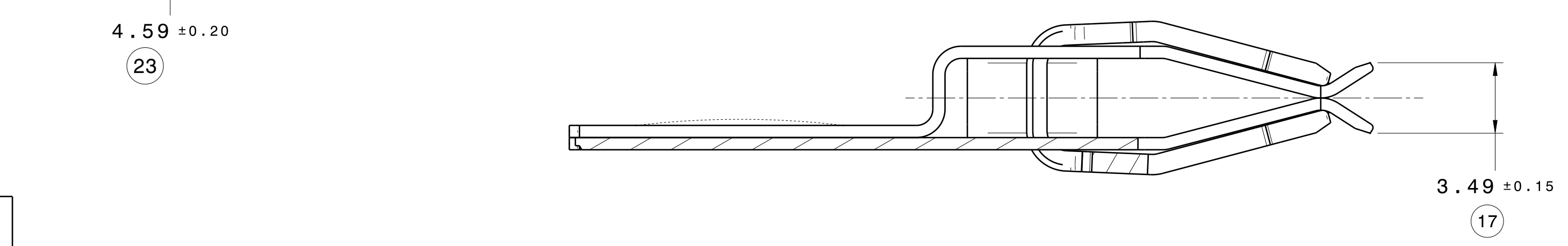

SECTION VIEW A-A

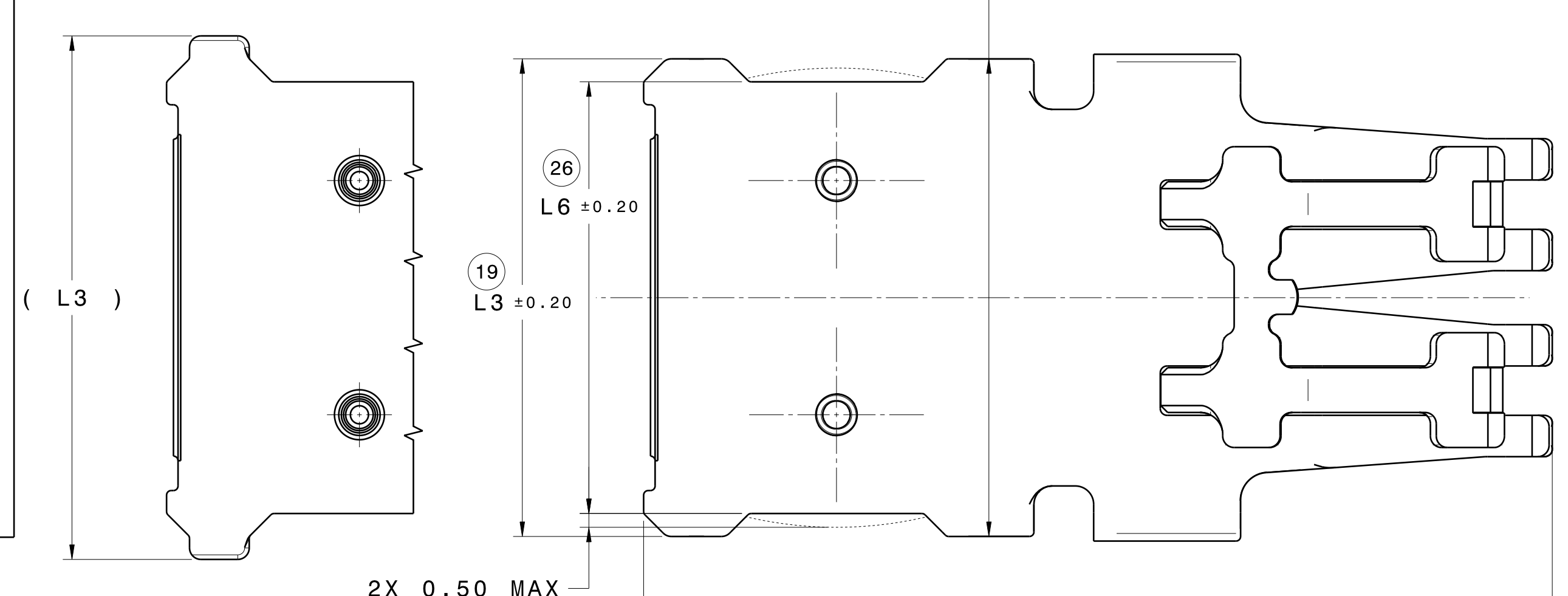

BOTTOM VIEW
GPN E05750900 & E22420300

BOTTOM VIEW

CHART 1

	ASSEMBLY GPN	ASSEMBLY DESCRIPTION	CONTACT GAP D	L1 +0.10/-0.40	L2 (REF)	L3 ±0.20	L4 (REF)	L5 ±0.20	L6 ±0.20	WIRE SIZE	ITEM NUMBER	QTY	COMPONENT DESCRIPTION	MATERIAL
	2B202011F	14.5HC AXIAL TOXED (STANDARD BODY)	0.00 +0.15 -0.00	39.80	17.00	20.80	10.00	20.80	18.80	≤ 60mm2	1	1	14.5HC TERMINAL BASE	C15100
	2B202021F	14.5HC AXIAL TOXED (EXTENDED BODY)	0.00 +0.15 -0.00	45.20	22.60	20.80	4.40	20.80	18.80	≤ 60mm2	2	1	14.5HC TERMINAL SPRING	301SS
NOT IN PRODUCTION	E00374700	14.5HC AXIAL TOXED (STANDARD BODY)	0.00 +0.15 -0.00	39.80	17.00	20.80	10.00	20.80	18.80	≤ 60mm2	2	1	14.5HC TERMINAL OVERALL NICKEL BASE	C15100
NOT IN PRODUCTION	E02671200	14.5HC AXIAL TOXED (STANDARD BODY)	0.00 +0.15 -0.00	39.80	17.00	20.80	10.00	20.80	18.80	≤ 60mm2	2	1	14.5HC TERMINAL OVERALL SILVER OVER NICKEL BASE	C15100
	E05750900	14.5HC AXIAL TOXED (EXTENDED TAB)	0.00 +0.15 -0.00	39.80	17.00	22.80	10.00	20.80	18.80	≤ 60mm2	2	1	14.5HC TERMINAL SPRING	301SS
	E22420300	14.5HC AXIAL TOXED (EXTENDED TAB WITH CONTACT GAP)	0.80 ± 0.20	39.80	17.00	22.80	10.00	20.80	18.80	≤ 60mm2	2	1	14.5HC TERMINAL SPRING	301SS

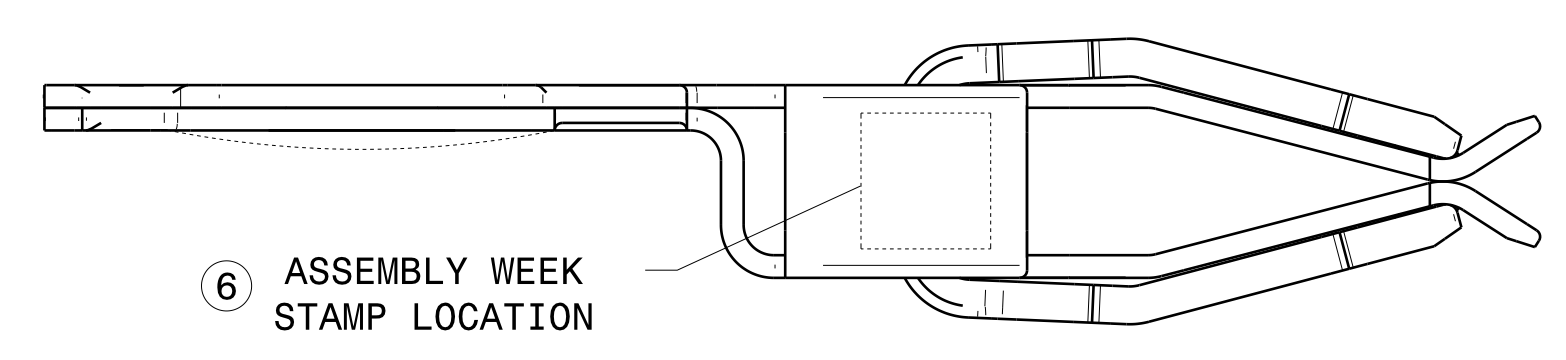

SIDE VIEW 2

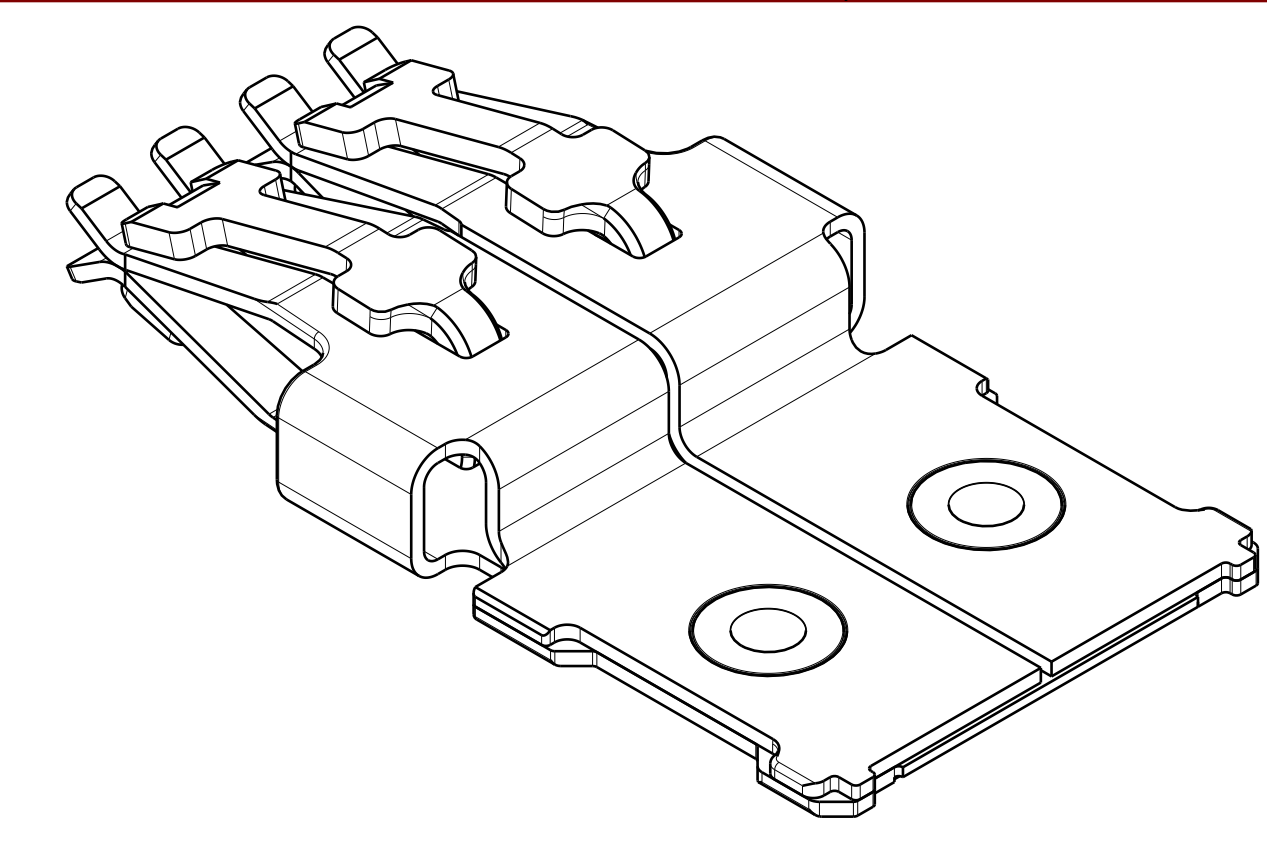

ISOMETRIC VIEW
Scale: 4:1

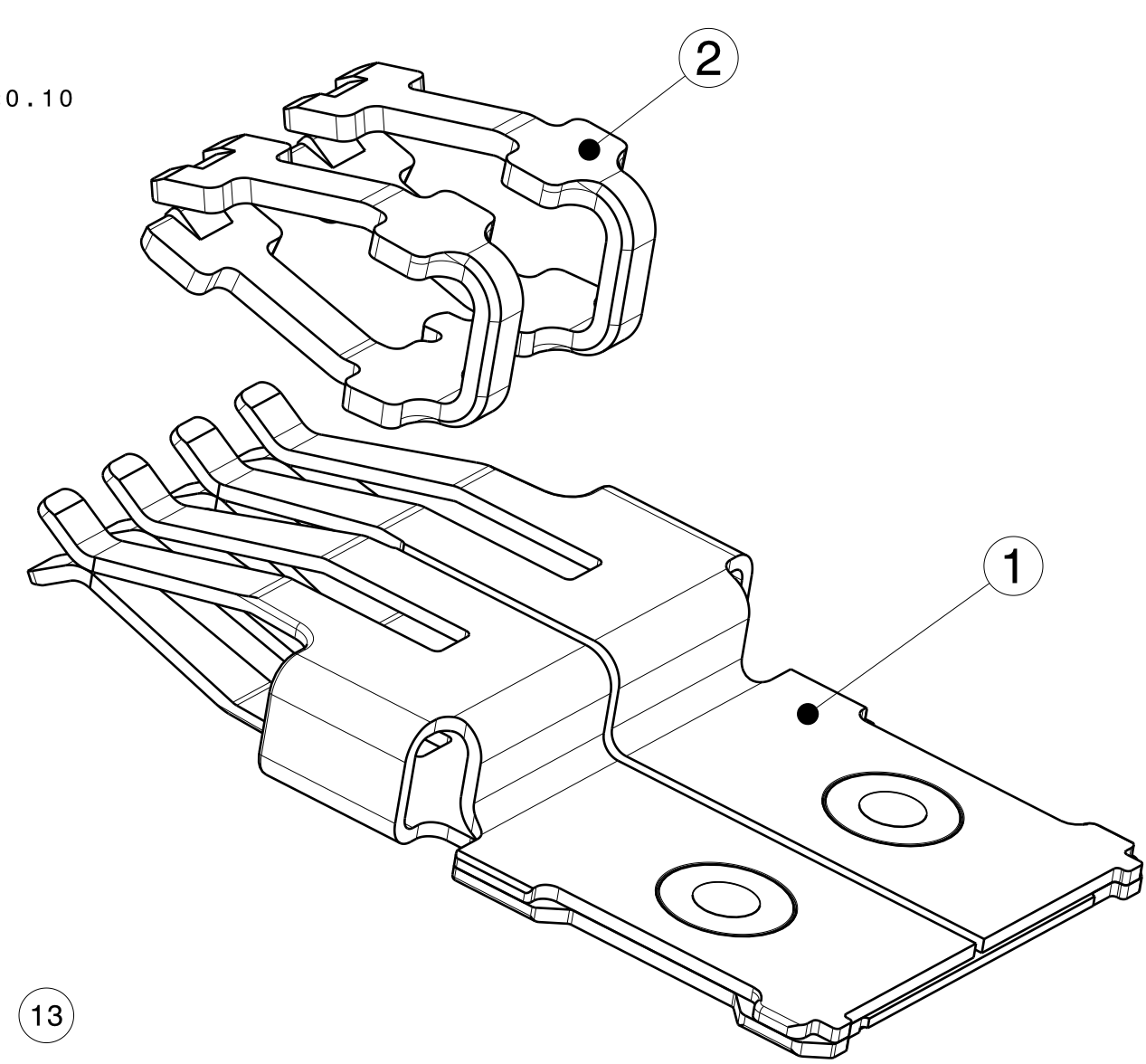

EXPLODED VIEW
Scale: 4:1

NOTES:

1. SPRING COMPONENT MUST BE FIRMLY ATTACHED TO THE BASE TERMINAL IN ASSEMBLY. NO SLIDING IS ALLOWED IN ANY DIRECTION.
2. PLATING IN TERMINAL BASE CONTACT AREA: SILVER PLATING OVER NICKEL.
3. UNLESS OTHERWISE SPECIFIED ALL DRAWING VIEWS SHOW GPN 2B202011F, 14.5HC AXIAL TERMINAL TOXED (STANDARD BODY) AFTER SINGULATION FROM TERMINAL CARRIER.
4. FOR ULTRASONIC WELDING GUIDELINES, SEE USCAR 38. THE WELD VALIDATION MUST ALSO COMPLY WITH THE USCAR 38.
5. FOR TERMINAL BLADE CONFIGURATION SEE DRAWING D00061263.
6. FOR TERMINAL CAVITY, SEE LEAR 14.5HC AXIAL TERMINAL CAVITY SPECIFICATION D00537558 OR D00540794.

REV.	ZONE	DESCRIPTION	CS/REL. NO.	DATE	DESIGNER	CHECKER
AA	-	GPN 2B202010F WAS GPN 2B202011F GPN 2B202020F WAS GPN 2B202021F INITIAL RELEASE OF SALES DRAWING	RN15184	2010/02/22	BJN	BJN
AB	-	CHANGED ASSEMBLY DESCRIPTION ADDED NOTCH TO CARRIER	RN16032	2010/06/06	BJN	BJN
AC	-	GPN 2B202011F WAS GPN 2B202010F GPN 2B202021F WAS GPN 2B202020F	RN18640	2010/12/01	BJN	BJN
AD	-	TOLERANCE CHANGE FOR L1 DIMENSION ADDED NEW ASSEMBLY E00374700 ADDED BLADE INTERFACE INFORMATION	RN25685	2012/04/12	ALS	ALS
AE	-	GPN 2B202011F AE WAS 2B202011F AD E00374700 WAS ADDED 13.85 +0.05/-0.25 WAS 13.85 ±0.15	RN32204	2014/05/10	PGC	PGC
AF	E5 E1	DDI #15 WAS 13.85 DIM 45.2 (REF) WAS 45.4 (REF) UPDATED CHART 1	RN41466	2015/03/12	PRM	PRM
AG	F3 D1, E3 F3	ADDED E00750900 TO CHART 1 ADDED BOTTOM VIEW GPN E00750900 ADDED L3 DIMENSION	RN43843	2015/05/15	SR	SR
AH	B1 C3 D1, E3 D5, D6	C15100 WAS C15100 3I AND, 1-0.60+0.02 301SS WAS 301SS FI, 1-1.00+0.025 NOTE 1, NO SLIDING WAS NO ROCKING OR SLIDING L3 ±0.20 WAS L3 & TOL. ±0.2/-0.1 WAS ±0.15	CS33598	2016/06/29	SR & DUP	SR & DUP
AJ	C3 D1	REVISED NOTE #4 REVISED CHART TO ADD WIRE SIZES DRAWING NO. WAS 2B202011F SALES	CN-0108648	2019/01/09	D. PROBERT	S. RAHMAN
AK	F1, F5 D7	ADDED PART NUMBER E22420300 DIMENSION #24 WAS 13.85 (REF)	CN-0111046	2019/07/31	R. SAGARTINO	S. RAHMAN
AL	D5	ADDED DIMENSION #25.	CN-0112322	2019/10/17	C. SOCO	S. RAHMAN
AM	H2	ADDED GPN E22420300 TO EXTENDED TAB FOR CLARIFICATION	CN-0113875	2020/04/03	C. SOCO	S. RAHMAN
AN	G2 E3 D1	ADDED GPN E22255700. REMOVED DIM 0.10 MIN & ADDED 0.50 MAX. ADDED CHARTED DIM L5, & L6. CHANGED WIRE SIZE TO 60 FOR ALL EXCEPT E22255700	CN-0114766	2020/07/15	R. SAGARTINO	S. RAHMAN
AP	D5, D6	REVISED SPRING HEIGHT TOLERANCES. REMOVED GPN E22255700. ADDED NOTE TO CHART 2 CHARTED CONTACT GAP D	CN-0117546	2021/05/26	A. BEING	S. RAHMAN
AR	D7	13.85 ±0.15/-0.65 WAS 13.85±0.15	CN-0117894	2021/06/25	R. SAGARTINO	S. RAHMAN

ANGLE PROJECTION	MATERIAL FINISH/SURFACE COLOR	SEE NOTES SEE NOTES	WEIGHT CAD	VOLUME CAD
NA		N/A	N/A	N/A

SCALE: 5:1

START DATE: 2013/05/02

DRAWN: PDC

APPROVERS: ENGR. S. RAHMAN, CHECKER. A. BUTCHER, APPROVER. B. RANGI

CAD DIRECTORY/LOCATION: DRAWING FILE NAME: 2B202011F-AR-CPN1-CAD.dwg
MODEL FILE NAME: 2B202011F-CATP.tbl

LAST UPDATE: 2021/06/25 SEM DOCUMENT ID: DRAWING NUMBER: 2B202011F REV: AR SHEET OF: 1 1 TYPE: CG

NOT USED 1,21

LAST USED 27



14.5HC AXIAL TERMINAL ASSEMBLY

CONFIDENTIAL - THIS DRAWING AND ALL INFORMATION DISCLOSED HEREIN ARE OWNED BY LEAR CORPORATION AND ARE NOT TO BE DISTRIBUTED OR DISSEMINATED IN ANY MANNER UNLESS EXPRESSLY AUTHORIZED IN WRITING BY LEAR CORPORATION