

THE MATING BLADE TIP CONFIGURATION, AND PLATING MUST BE PER LEAR BLADE SPECIFICATION D00430475.

**PLATING:**  
ELECTROPLATED SILVER 3.0 MINIMUM OVER 1 - 1.5 μm THICK SULFAMATE NICKEL. SILVER PLATING PER ASTM B700; TYPE I; GRADE D; CLASS S, WITH ANTI-TARNISH COATING OF TARNIBAN KSII POST TREATMENT. NICKEL PLATING PER ASTM B689; TYPE I; CLASS X; STANDARD MATTE FINISH.

**INTERFACE TO BLADE**  
Scale: 5:1

**CHART 1**

ASSEMBLY GPN	ASSEMBLY DESCRIPTION	Dimension A MAXIMUM	Dimension B	Dimension C	Dimension D	Dimension T	PRODUCT CODE	ORIENTATION CODE	WIRE SIZE (mm <sup>2</sup> )	BILL OF MATERIAL			
										ITEM NUMBER	QTY	COMPONENT DESCRIPTION	MATERIAL
E07412200	6.3 HC TERMINAL 0.80 BLADE LOW INSERTION	0.45	4.85	2.94	2.24	0.80	4	A	≤ 16	1	1	6.3HC TERMINAL BASE	COPPER ALLOY
										2	1	6.3HC TERMINAL SPRING	SS
E07412300	6.3 HC TERMINAL 1.00 BLADE LOW INSERTION	0.60	4.86	3.23	2.53	1.00	6	B	≤ 16	1	1	6.3HC TERMINAL BASE	COPPER ALLOY
										2	1	6.3HC TERMINAL SPRING	SS
E07412400	6.3 HC TERMINAL 1.20 BLADE LOW INSERTION	0.80	5.07	3.51	2.82	1.20	8	C	≤ 16	1	1	6.3HC TERMINAL BASE	COPPER ALLOY
										2	1	6.3HC TERMINAL SPRING	SS

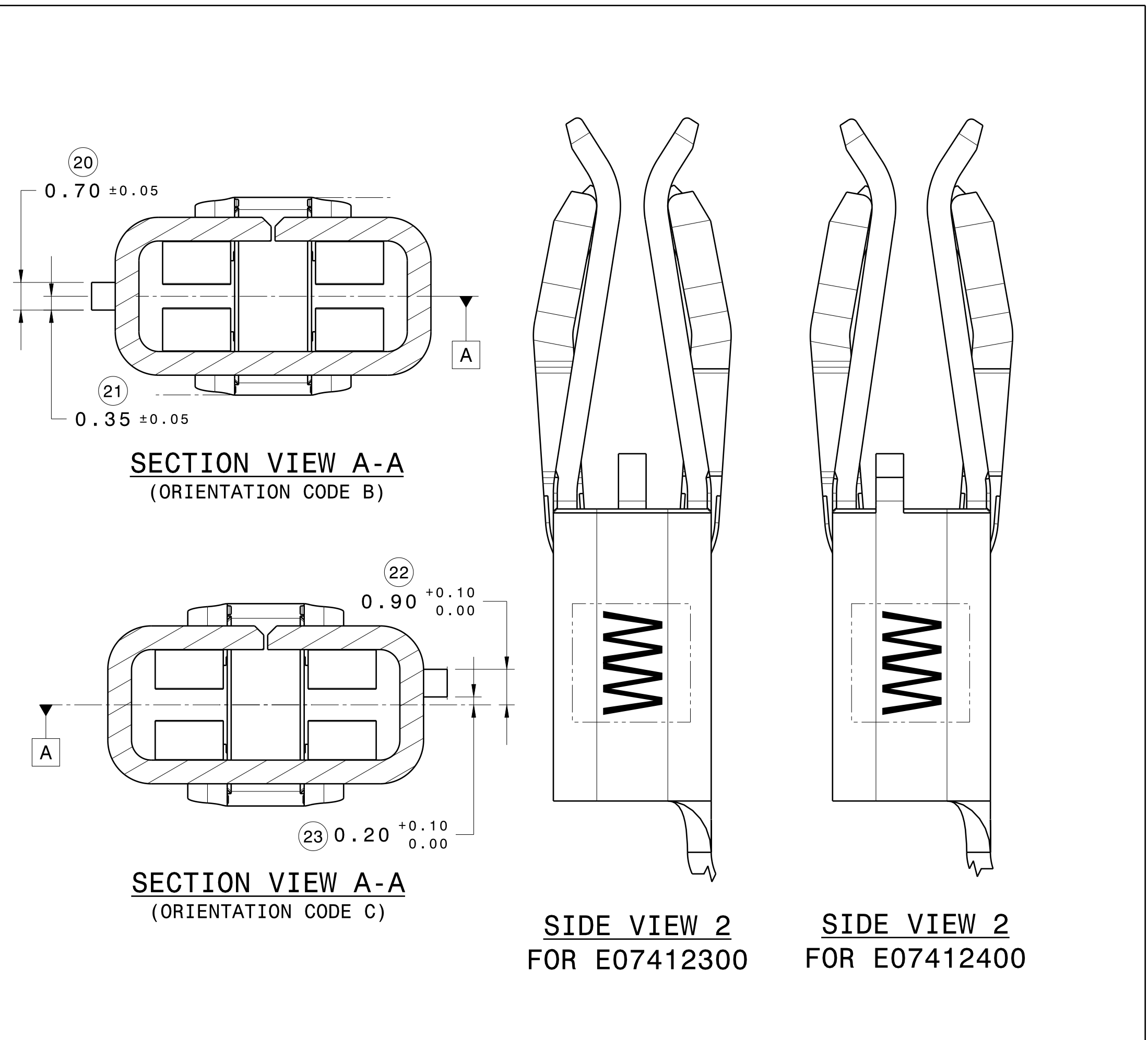
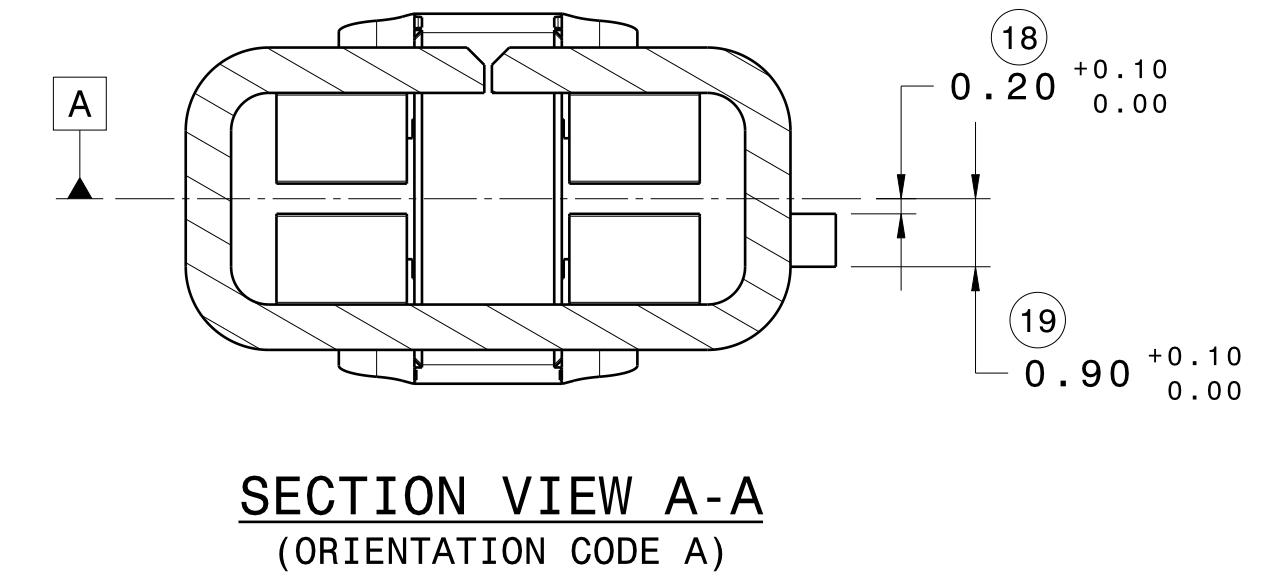

- NOTES:**
- GENERAL TOLERANCES
    - ONE PLACE DIMENSIONS ±0.20
    - TWO PLACE DIMENSIONS ±0.10
    - ANGULAR DIMENSIONS ±2°
  - BASE TERMINAL MATERIAL: COPPER ALLOY, 0.60 ±0.019 THICK  
SPRING MATERIAL: STAINLESS STEEL, 1.00 ±0.025 THICK
  - PLATING IN TERMINAL BASE CONTACT AREA TO BE SELECTIVE SILVER PLATING OVER SULFAMATE NICKEL UNDERPLATING.
  - PARTS MUST BE SHIPPED FREE FROM ANY MANUFACTURING AGENT (CUTTING FLUIDS, OILS, RESINS, WAXES, SOLVENTS, AND CHEMICALLY INDUCED OR EXTERNALLY DEPOSITED RESIDUES). NO DEBRIS (PLASTIC OR METAL) ALLOWED IN SHIPPING PACKAGE.
  - SHIPPING PACKAGE MUST NOT DAMAGE PRODUCT DURING TRANSIT.
  - UNLESS OTHERWISE SPECIFIED ALL DRAWING VIEWS SHOW GPN E07412200.
  - LEAR "L" STAMP AND ASSEMBLY DATE STAMP WW = WEEK, YY = YEAR, MUST BE LOCATED ON THE SIDES OF THE BOX. TEXT MUST BE LEGIBLE.
  - COIN PERMISSIBLE AT THE SEAM AREAS OF THE BOX.
  - SCORES USED TO HELP FORMING THE BOX ARE PERMISSIBLE. THE DEPTH OF SCORE NOT TO EXCEED 10% OF MATERIAL THICKNESS.
  - UNLESS OTHERWISE SPECIFIED ALL DRAWING VIEWS SHOW TERMINAL AFTER SINGULATION FROM CARRIER.
  - FOR ULTRASONIC WELDING GUIDELINES SEE USCAR 38. TERMINAL VALIDATION PER USCAR 2, ULTRASONIC WELDING VALIDATION PER USCAR 38
  - FOR TERMINAL CAVITY, SEE LEAR 6.3HC TERMINAL CAVITY SPECIFICATION D00452785.

REV.	ZONE	DESCRIPTION	CS/REL. NO.	DATE	DESIGNER	CHECKER
AA		RELEASED FOR PRODUCTION	CS 323651	2016/07/12	PKC	M.GLOCK
AB	E2,E3,F3,F4	ADDED DIM # 20, 21, 22 & 23	CS 333436	2016/09/14	PKC	M.GLOCK
	D3	ADDED GENERAL TOL. NOTE				
	D4	ADDED MATERIAL NOTE 1				
	D4	6.04 HAS 0.0				
AC	D8	ADDED DATUM D, ADDED TERMINAL CAVITY SPECIFICATION NOTE #12, RENUMBERED NOTES.	CS 345493	2018/07/26	C. SOCO	S. RAHMAN
	D2,D3	#11 ADDED MATING BLADE PLATING REQUIREMENTS.				
	C1	ADDED COIN, REVISED WIRE SIZE.				
	E1	5.07mm SPRING HEIGHT FOR 0.80mm GAP VERSION HAS 4.80mm.				
AD	D3,D2	REVISED NOTES #4 & #11.	CH-0108264	2018/11/23	F.ANTIDA	S. RAHMAN
AE	E1	0.45 HAS 0.40 FOR DIM. A.				
	--	DRAWING NO WAS ED7412200C.				
	D2	REVISED NOTE #11.	CH-0115321	2020/09/03	R. SAGARINO	S. RAHMAN
	E1	4.85 HAS 4.81 FOR DIM. B.				

ANGLE PROJECTION: NA

MATERIAL FINISH/SURFACE: N/A

WEIGHT CAD: N/A

VOLUME CAD: N/A

SCALE: 10:1

START DATE: 2015/11/06

DRAWN: P. CASTELLANI

APPROVED: ENGR. S. RAHMAN, CHECKER: R. BUTCHER, APPROVER: L. GALLIGAN

TITLE: 6.3HC WELD WITH POLARIZATION CODES TERMINAL ASSEMBLY CUSTOMER

CAD DIRECTORY/LOCATION: SEM

DRAWING FILE NAME: ED7412200-AE\_DWG\_CAD(Drawing)

MODEL FILE NAME: ED7412200-099-0002\_CAD(Drawing)

LAST UPDATE: 2020/09/03

SEM DOCUMENT ID: DRAWING NUMBER: E07412200

REV: AE

SHEET: 1

OF: 1

TYPE: CG

NOT USED: 27

CONFIDENTIAL - THIS DRAWING AND ALL INFORMATION DISCLOSED HEREIN ARE OWNED BY LEAR CORPORATION AND ARE NOT TO BE DISTRIBUTED OR DISSEMINATED IN ANY MANNER UNLESS EXPRESSLY AUTHORIZED IN WRITING BY LEAR CORPORATION